

# Parking Pawl

CONTINUOUSLY VARIABLE TRANSMISSION

## 36.Parking Pawl

### A: REMOVAL

- 1) Remove the transmission assembly from the vehicle. <Ref. to CVT(TH58A)-63, REMOVAL, Automatic Transmission Assembly.>
- 2) Remove the extension case. <Ref. to CVT(TH58A)-182, REMOVAL, Extension Case.>
- 3) Remove the transfer clutch assembly. <Ref. to CVT(TH58A)-186, REMOVAL, Transfer Clutch.>
- 4) Remove the transfer driven gear assembly. <Ref. to CVT(TH58A)-200, REMOVAL, Transfer Driven Gear.>
- 5) Remove the transfer drive gear assembly. <Ref. to CVT(TH58A)-203, REMOVAL, Transfer Drive Gear.>
- 6) Remove the parking pawl shaft, return spring and parking pawl.

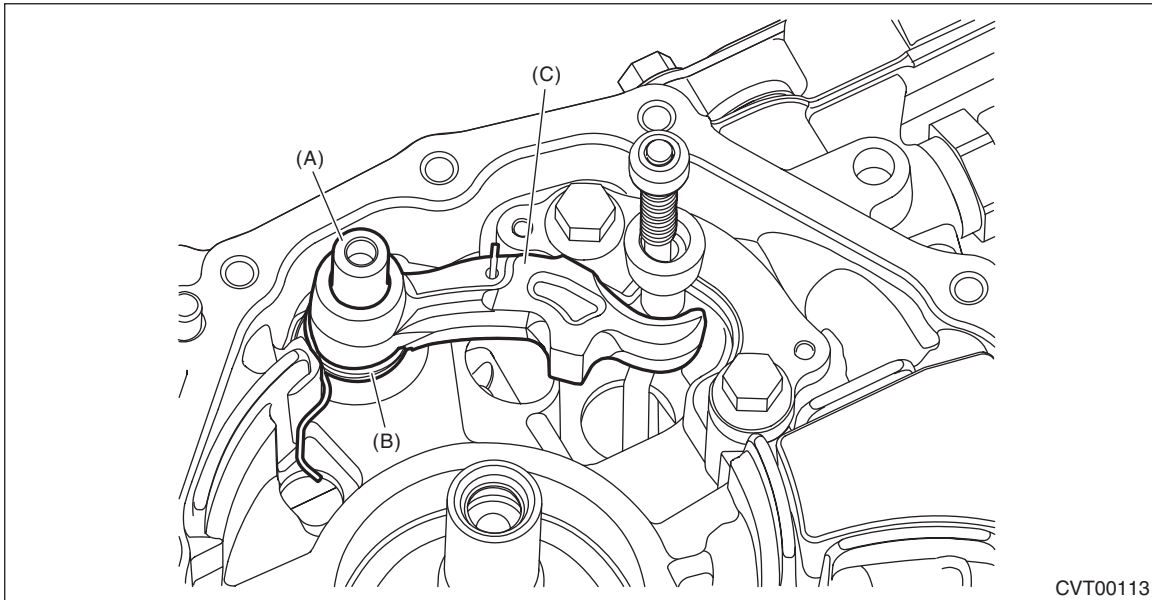

- (A) Parking pawl shaft
- (B) Return spring
- (C) Parking pawl

### B: INSTALLATION

- 1) Set the range select lever to the "N" range.
- 2) Install the return spring to parking pawl.

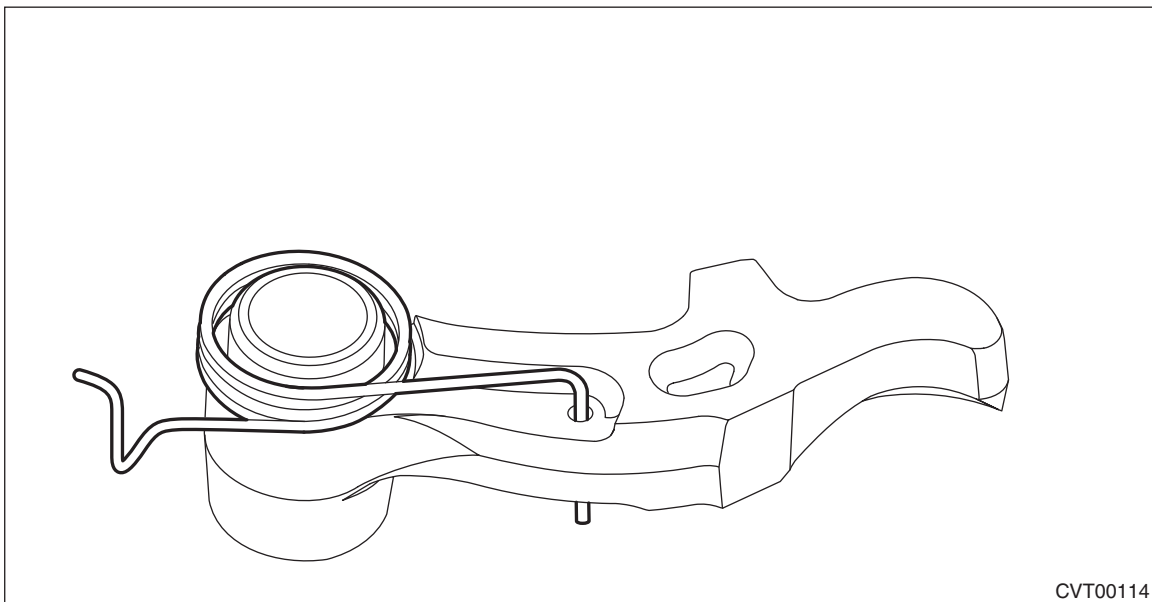

3) Install the parking pawl and parking pawl shaft.

**NOTE:**

Make sure that the end of return spring sticks out of the hole of parking pawl as shown in (a). Make sure that the other end contacts the rib of transmission case as shown in (b).

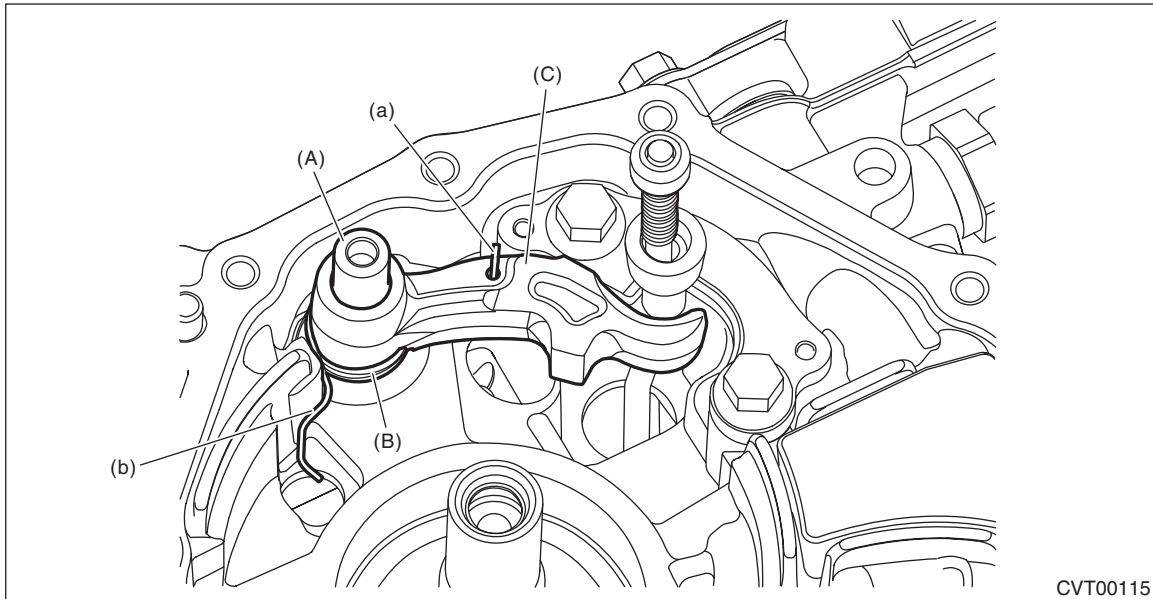

- (A) Parking pawl shaft
- (B) Return spring
- (C) Parking pawl

4) Install the transfer drive gear assembly. <Ref. to CVT(TH58A)-204, INSTALLATION, Transfer Drive Gear.>

5) Install the transfer driven gear assembly. <Ref. to CVT(TH58A)-201, INSTALLATION, Transfer Driven Gear.>

6) Install the transfer clutch assembly. <Ref. to CVT(TH58A)-188, INSTALLATION, Transfer Clutch.>

7) Install the extension case. <Ref. to CVT(TH58A)-183, INSTALLATION, Extension Case.>

8) Install the transmission assembly to the vehicle. <Ref. to CVT(TH58A)-77, INSTALLATION, Automatic Transmission Assembly.>

## C: INSPECTION

- Check the parking pawl for breakage or damage.
- Check for worn, broken and/or damaged return spring.